



El Foto
Gente

OneView

Sales Tool Overview



OneView

A Different Way of Selling Homes

Discover how EFG is transforming the sales and marketing experience of Gated Communities throughout Riviera Maya giving agents the tools they need to sell effectively and reach higher than ever before.

The Daily Grind

Everyday your agents and sales teams are up against the odds.

- **Weather & Logistics** – Storms can derail showings and make planning a visit to your gated community a near impossibility. Besides darkened clouds and high winds don't make the best backdrop.
- **Inconsistent Showings** – Birthday parties at a Club House, misplaced Showroom keys, lack of electricity, and pools under renovation, can force agents to skip amenities and valuable assets, meaning families don't always see you at your best.
- **Conventions & Events** – They are loud, fast, and if your team doesn't have the right information on display right when they need it, clients fall through the cracks before they even get their phone number.

It's not that people aren't interested, there are just obstacles getting in your teams way at every turn.



Let's Remove the Friction And Get Things Flowing.

You need controlled consistency, faster discovery, something that can reach clients wherever they are day or night, that let's you quickly get their information and close the deal before they leave. Even more, you need a memorable branded image that they won't forget amongst the handful of other gated communities they talked to this week.



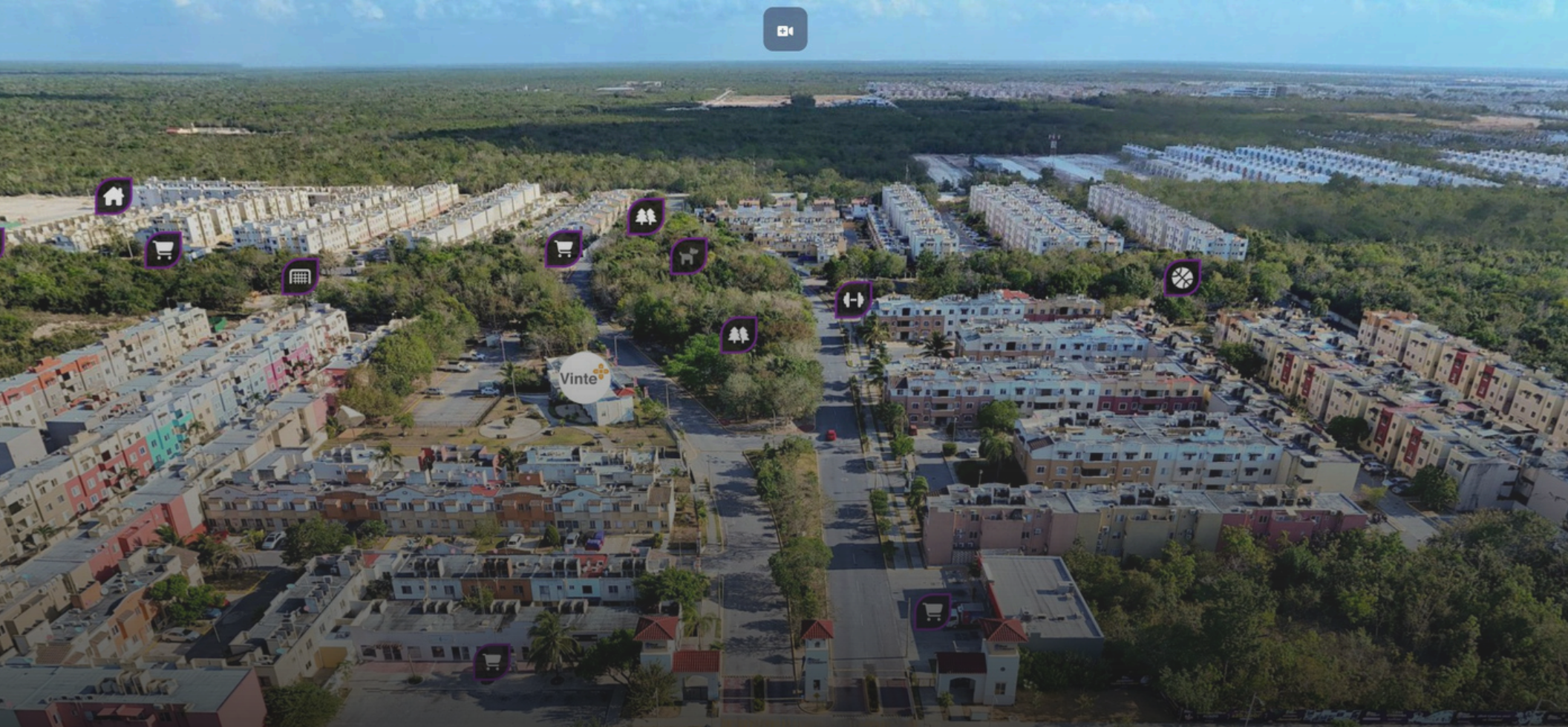

Introducing OneView

A faster, simpler way to sell homes: Giving your agents the tools they need to compete in an ever-changing market. With features like property cards that help you locate available homes quickly, a fully immersive go-anywhere style walk-thru, filled with interactive hotspots for videos and photo galleries...OneView isn't a tour, **it's a sales tool unlike anything you've seen before.**

Feature Overview

OneView is jam-packed with features to take your team from being everyday sellers to real estate rockstars.

- Branded Side Menu
- Nadir Patch with Your Logo
- Splash Screen
- POI 360 and Community Overview
- 2D Floorplans and Exterior Maps
- Video Hotspots
- Photo and Document Galleries
- Property Cards
- Product Cards with Variations
- Wishlist Calculator
- Favorites and Hidden Tags
- Export to WhatsApp
- Language Toggle (EN/ES)

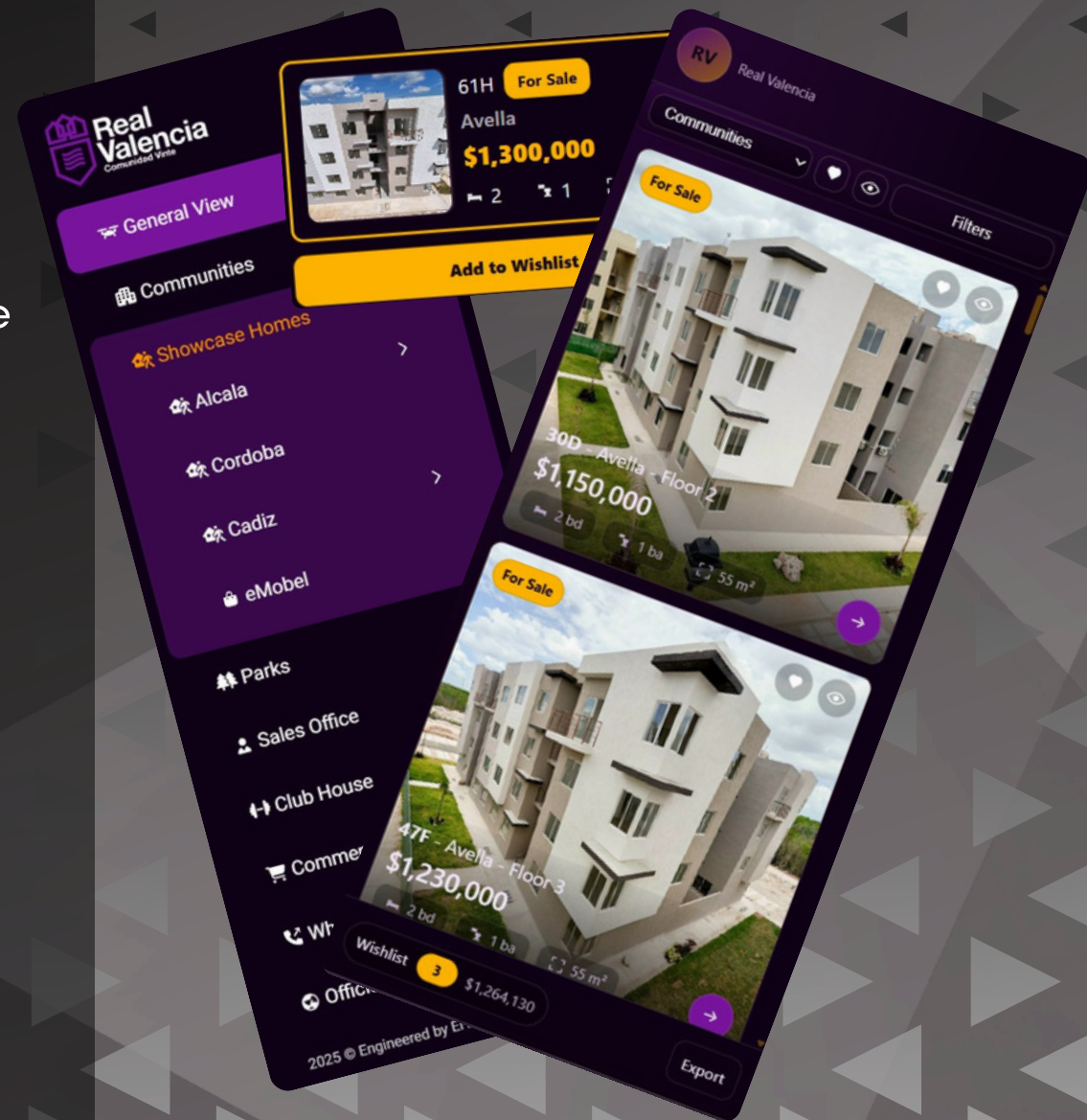

Vista General

Privadas

Muestras

Alcala

Sala

Cocina

Baño

Recamara #1

Recamara #2

Patio

Cordoba

Cadiz

eMobel

The Side Menu

Quickly navigate to a specific building, home, or room, with a few clicks, all while showing logos and colors that match your brand. Add links to specific galleries, websites, or add a quick link to your WhatsApp so clients can send inquiries on their own time.

Language Toggle

Switch between English and Spanish, immediately changing menus, hotspots, and more.





Nadir Patch

Rather than a blur, tripod, or a hideous black spot covering the base of your showroom images, we show your branded logo in each ground-based panorama we take.

2D Maps/FloorPlan

Navigate seamlessly and always know where you are in the virtual tour. With over 25+ panoramas per showroom, go anywhere, see everything, all on one screen.

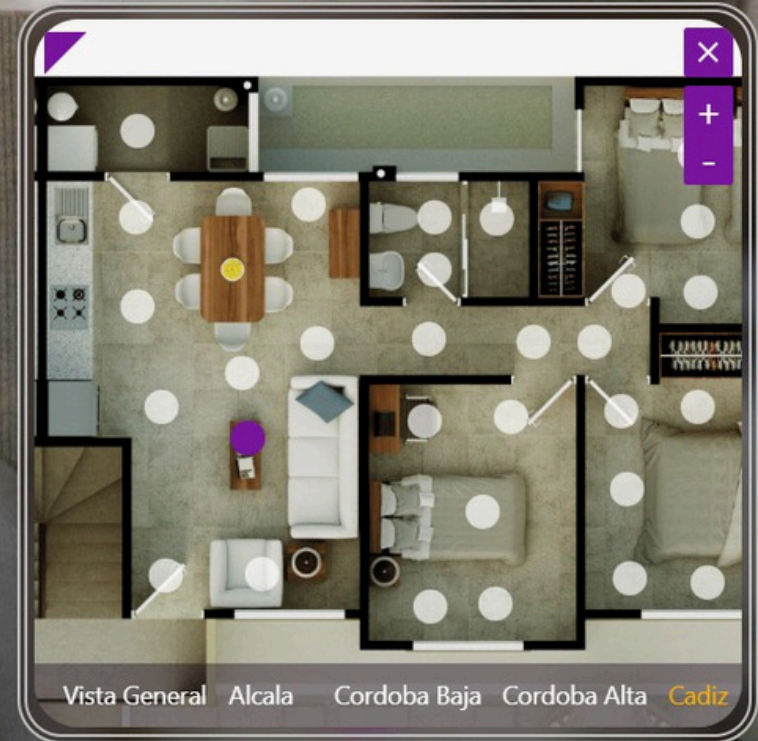



Video Hotspots

Integrate your Youtube videos and Youtube Shorts directly into the virtual tour, and gain all the familiar video controls like play/pause, volume control, closed captioning, and more. Watch in Fullscreen mode or cast to a tv to show off a space in dynamic detail.

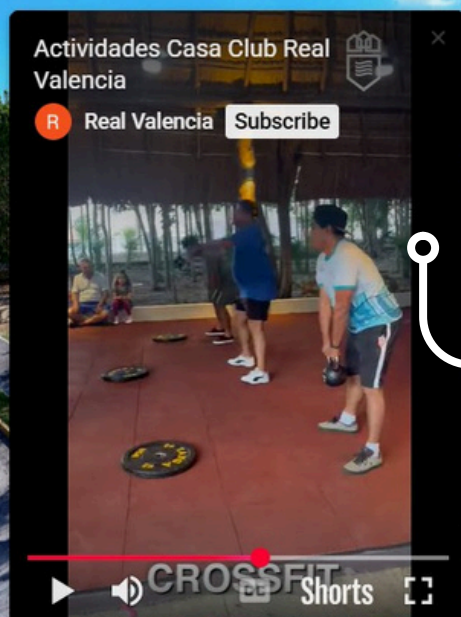

POI 360

Make your clients fall in love with your community's location by showing them all the local places of interest, like shopping centers, airports, and beaches, with an interactive map that shows real distances, routes, and drive time.

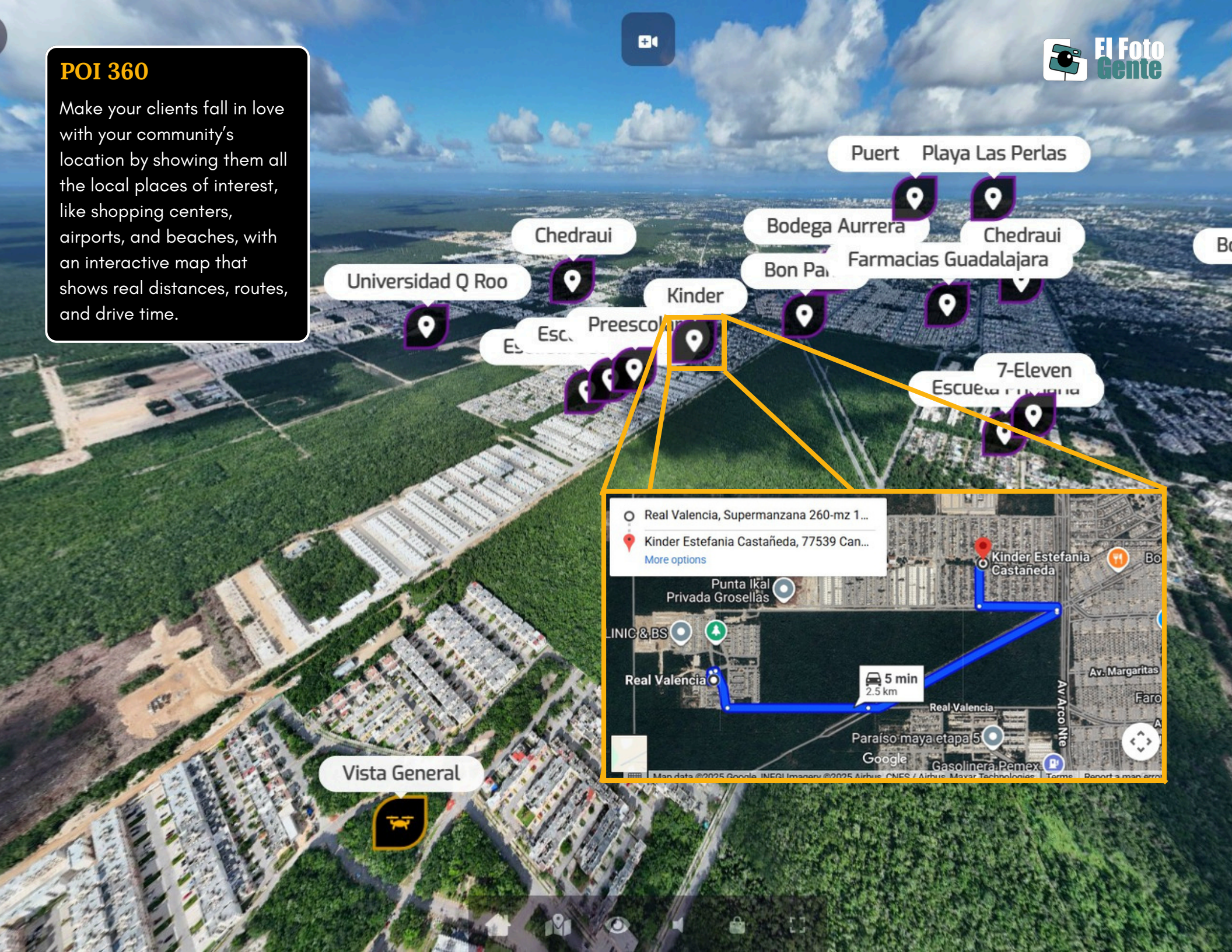

Wishlist Calculator + Product Cards

Help your clients envision their dream home with product cards that show all the available accessories you have to offer. Then add them together with the price of the home to aid in calculating which home and accessories best fit their budget.





Mueble de TV



- Suministro e instalación de mueble de TV
- Medida 2.26 – 2.20

SKU: 16307
PRICE: \$24,480

Agregar Mueble de TV

RV Real Valencia

Privadas



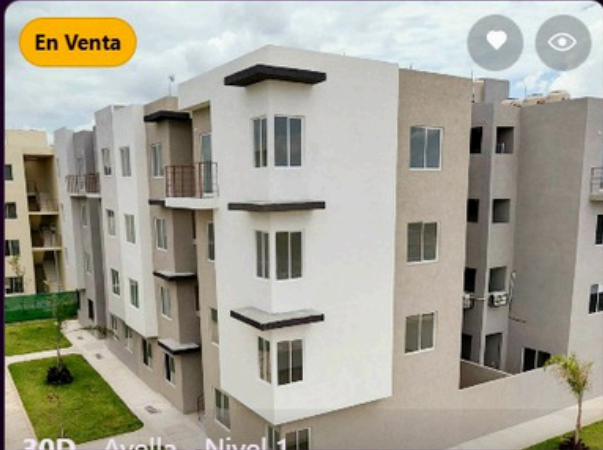

Filtros

En Venta



Mi Hogar Ideal

\$1,356,480

61H - Casa	\$1,300,000	
16307 - Mueble/TV	\$24,480	
16156-C2 - Closet 3	\$32,000	
Total: \$1,356,480		<div>Borrar</div>

Mi Hogar Ideal

3

\$1,356,480

Exportar

Property Cards + Side Bar Filters

Use the Side Bar's Filter Panel to quickly narrow down the list of available homes to the one your client most desires. Search by bedroom count, floor number, budget and more. Add the properties to your favorites, or hide the properties that are a bad match. Then close the deal by adding it to the Wishlist for a quick estimate.

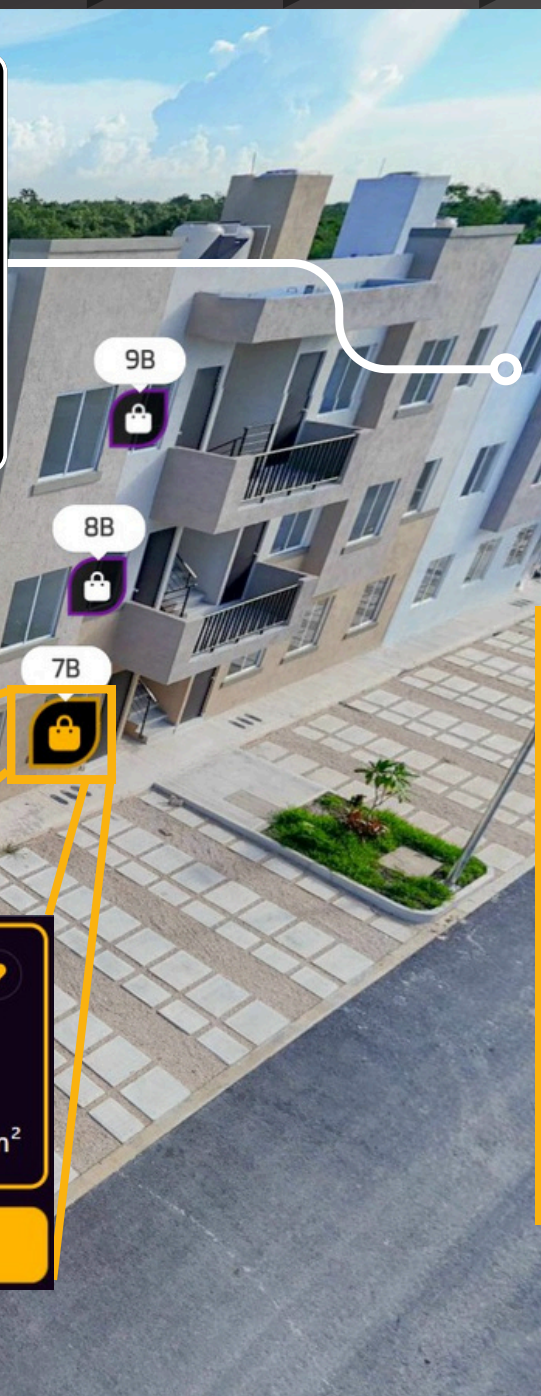



7B En Venta

Gandia

\$1,682,600

3 hb 1 ba 64.97 m²

Agregar a Wishlist

RV Real Valencia

Privadas

Filtros

Habitaciones: 2+ 3+

Niveles: PB

Tienes Balcon

Tienes Patio

Precio: 1089000 1754000

Borrar

\$1,682,600

3 hb 1 ba 65 m²

En Venta

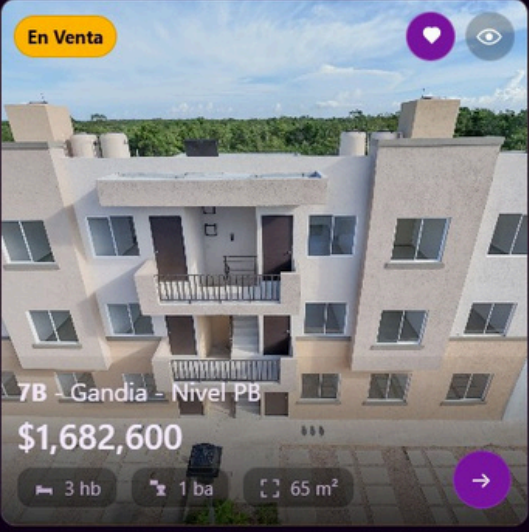

7B - Gandia - Nivel PB

\$1,682,600

3 hb 1 ba 65 m²

En Venta

Mi Hogar Ideal 3 \$1,356,480

Exportar

Export to WhatsApp/Copy to CRM

Whether you are at an event or in-the office, send a smart summary of the properties your client loved and which accessories they'd love to add direct from the tour. Ensuring they remember your community, your agents, and making that chance encounter feel all the more ever-lasting and personal.

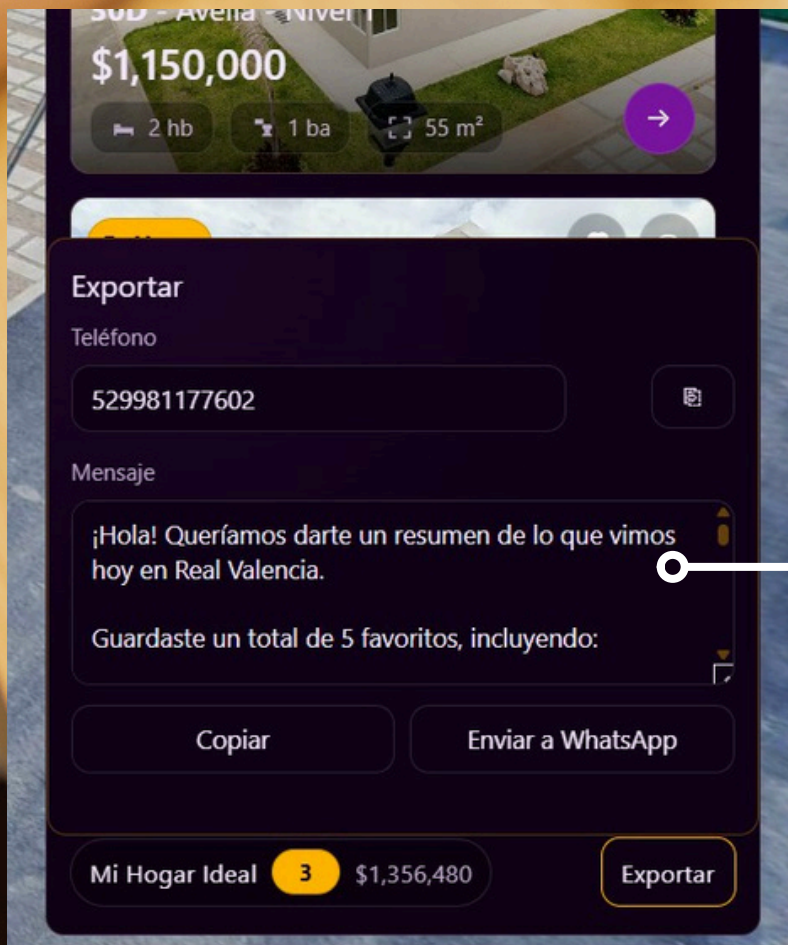

¡Hola! Queríamos darte un resumen de lo que vimos hoy en Real Valencia.

Guardaste un total de 5 favoritos, incluyendo:

- 23C - \$1,089,000
Avella - Nivel 2
2 hb | 1 ba | 55 m²
- 61H - \$1,300,000
Avella - Nivel PB
2 hb | 1 ba | 55 m²
- 1A - \$1,752,780
Gandia - Nivel PB
3 hb | 1 ba | 65 m²
- 72L - \$1,299,000
Gandia - Nivel 2
3 hb | 1 ba | 66 m²
- 7B - \$1,682,600
Gandia - Nivel PB
3 hb | 1 ba | 65 m²

También agregaste 3 artículos a tu Lista de deseos, incluyendo:

- 61H - \$1,300,000
Avella - Nivel PB
2 hb | 1 ba | 55 m²
- 16307 - Mueble/TV - \$24,480
- 16156-C2 - Closet 3 - \$32,000

Lo cual sumó un total de \$1,356,480.

Esperamos que te sea útil esta información y, si tienes preguntas, responde a este mensaje.

Atentamente,
... [Read more](#)

2:04 PM



v3.2.0 - OneView Demo
Tour
tours.elfotogente.com



<https://tours.elfotogente.com/F1V3YAJdHm/45039225p&0.05h&64.57t>

2:18 PM

Message



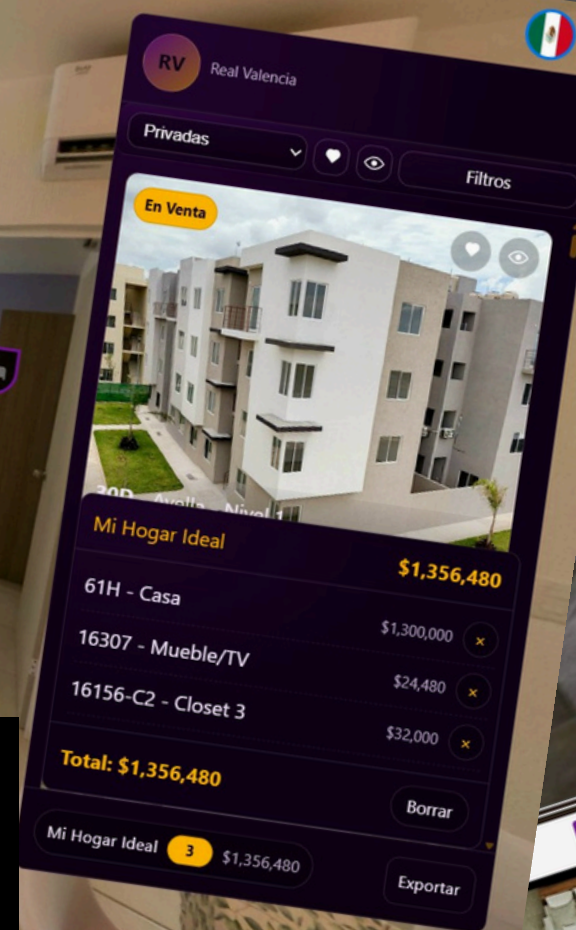

And that's just some of the many features that come standard with OneView.

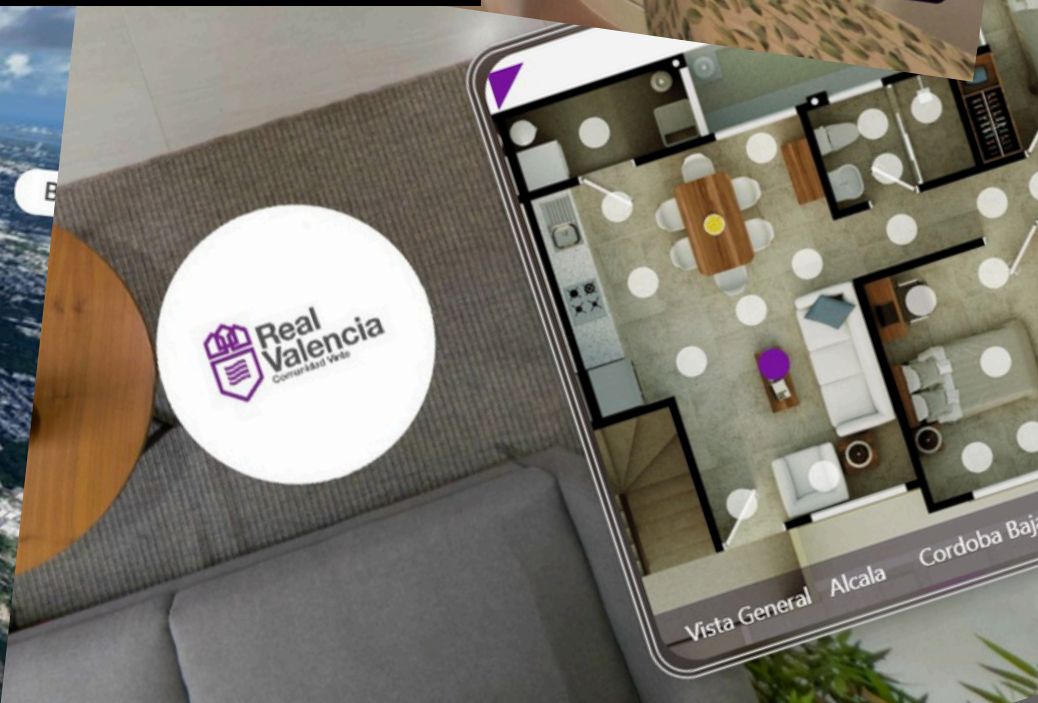



Meet Andrea & Mateo

Married 5 years with two kids, Andrea and Mateo are tired of living in their small rental and have decided to get something of their own in a quiet neighborhood. With only weeks to decide to either renew their lease or not, they are looking for a home with a large kitchen for Andrea, a kindergarten nearby to ease the commute for their two toddlers, and that isn't too far from the airport for when Mateo needs to travel for work. While browsing Facebook, Andrea finds your community and is curious to learn more. With a budget of only \$1,200,000mxn and the need for a two bedroom, Mateo's not sure of what his options are, but he makes the choice to visit your office anyway.

1

The Agent opens OneView, clicks the **POI 360 Pano**, and from the aerial view shows nearby kindergartens, pans to the airport, clicks its icon, reviews different routes, and they agree a drive time of 25 minutes is manageable.

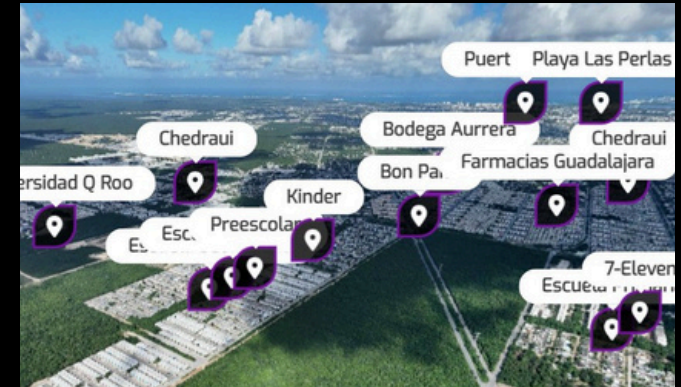

2

The Agent jumps straight into the **Sidebar** looking for the perfect home, opens **Filters** and sorts by bedroom size, budget, location within the community, and asking floor preferences. Within seconds they've narrowed down the list of homes from 50 to 5.



3

They **Favorite** a few and **Hide** others. The Agent opens the **Floor Plan** to show kitchen sizes and does a tour of the homes. Deciding on a match, the Agent clicks **Export** and sends the info directly to his phone via WhatsApp, saving his name, number, and preferences in the process.



Communities Trust EFG

Unlimited Panos for Full Coverage

We capture your entire community: Interior, Exterior, Ground-based and Aerial, adding as many photos as we can manage and color correcting every last one.

We Take Client Feedback Serious

Many of our best features came to be from the gracious feedback that we gained from communities just like yours. Features like the POI 360 and the Wishlist came from the needs of real agents out in the field, who simply had an idea.

Event Partnerships

We often attend events alongside communities for free, giving real-time support to sales teams and backup tablets, providing a level of reassurance no other company can match.



El Foto Gente

From Capturing to Captivating

1) Questionnaire and Quote Meeting

You complete a questionnaire that covers needs, coverage, and contacts. Within 3 days we schedule a meeting and give you a quote.

2) Shoot Day (9a-3p)

We arrive on location, meet with our point of contact and get to work capturing your community inside and out, until we have full coverage.

3) Build & QA

We edit panos, link navigation and hotspots, assemble your sales tool with the data you provided, then run a Quality Assurance check to reduce errors.

4) Launch Date

Within 10 Business Days you receive the link to your live sales tools. You provide feedback for any minor changes and we make improvements.

5) Training

You schedule a training day and we arrive on location to train your team in-person and audit customer interaction for real-time performance tweaking.

6) Live Updates

We send you UX updates regularly and with 4 work orders per month, we upload new photos, change data, text, links, and more, so you're always current.

Pricing & Plans

OneView Sales Tool

Now Available!

\$80,000 MXN One-Time Setup

Setup Fee covers:

- Capture of all 360 Panoramas
- Photo Editing and Color Correction
- Linking and Navigation
- Virtual Tour Creation
- Gallery Hotspot Creation
- Product and Property Card Creation
- Data Entry and Sales Tool Creation



\$4,000 MXN/Month Support

Support Fee covers:

- Hosting with Unlimited Panoramas and 2D Photos.
- Maintenance with ongoing content updates for text, links, property data, etc.
- Up to 4 Work Orders Per Month
- Access to Reshoots at reduced rates.



SAT Factura Ready!
All Mexican Bank
Transfers Accepted.



No Travel Fees within
Quintana Roo From Cancun
to Playa Del Carmen



Two-Part Payment Plans
Available!
Pay up to 3 months apart.

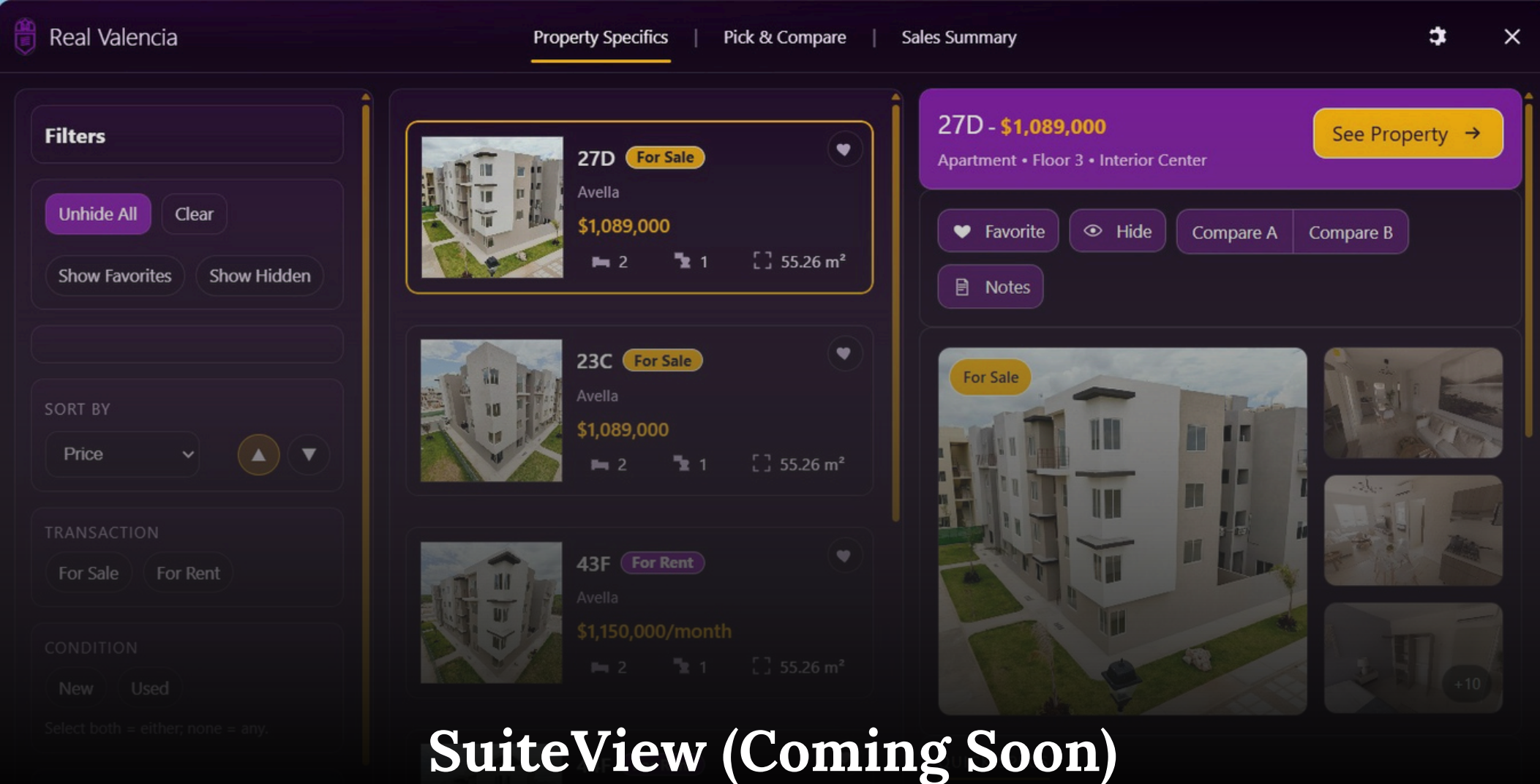

SuiteView (Coming Soon)

If you loved OneView's fast pace sales platform, then get ready to have your socks blown off with SuiteView from EFG, a full comprehensive sales platform with elaborate filters, built-in galleries for every property, property notes, live property comparisons, client accounts, full-screen floor plans, and more! Coming **January 17th**. Pre-order now available!